

DESCRIPTION

CNFWO-04F is used for different kinds of modules and applied to the working area subsystem. It uses embedded surface frame, easy to install and disassemble, it is with protective door and dusty free. With application of fiber SC/LC simplex, duplex and other different environment installed plate or flush plate. All modules can be configured on customer' s choice. Cable management can be connected without cutting (with express port). All modules are free of welding.

APPLICATION

- The telecommunication network, metropolitan area network, optical fiber communication system;
- Optical testing equipment/instrument;
- CATV optical fiber, optical fiber sensor;
- Optical fiber broadband access network, FTTH optical fiber;
- Optical fiber distribution frame, frame type and wall type optical fiber distribution unit.



SPECIFICATIONS

Item	Technical data
Application	3.0 x 2.0 mm drop cable or indoor cable
Fiber diameter	125μm (652 & 657)
Tight cladding diameter	250μm & 900μm
Mode of application	Single mode & duplex mode
Tensile strength	>50 N
End-use temperature	-40~+85°C
Adapter	SC & LC
Insertion loss	≤0.2dB (1310nm & 1550nm)
Output	4

CONFIGURATION TABLE

Model	Size (Pic 1)	Max Capacity			Installation Size (Pic 2)
	A*B*C (mm)	SC	LC	PLC	D (mm)
CNFWO-04F	100.6*80.6*28.8	4	8	8	80

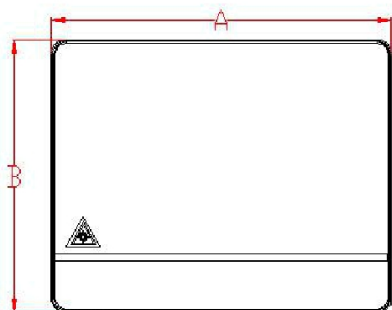

Pic 1 Box Size

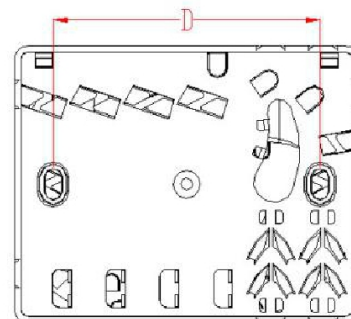
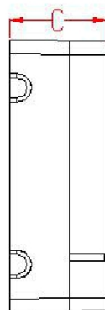

Pic 2 Installation Size



PRODUCT CABLE WAYS

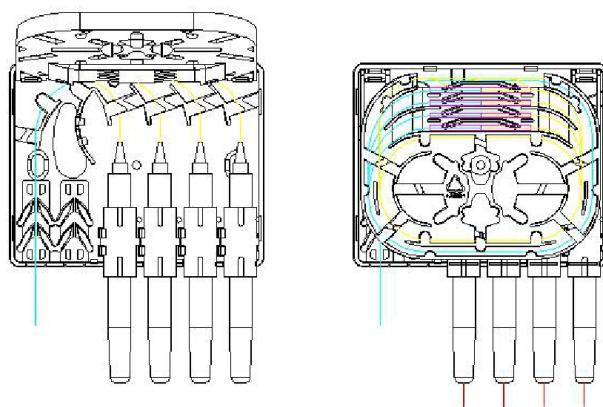

Pic 3 Cable ways

INSTALLATION

Wall-mounted installation

Drill 2 holes over the wall based on the size in Configuration table, place the expansion bolt $\Phi 5.5 \times 30$, place the box to match up the holes and use bolt to fasten. (see Pic 4)

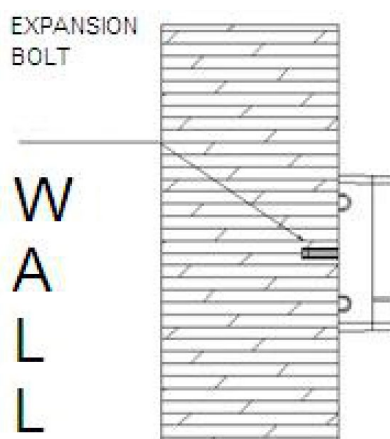

Pic 4 Wall-mounted installation